

# QUANTUM9

Precision. Fabrication. Control.

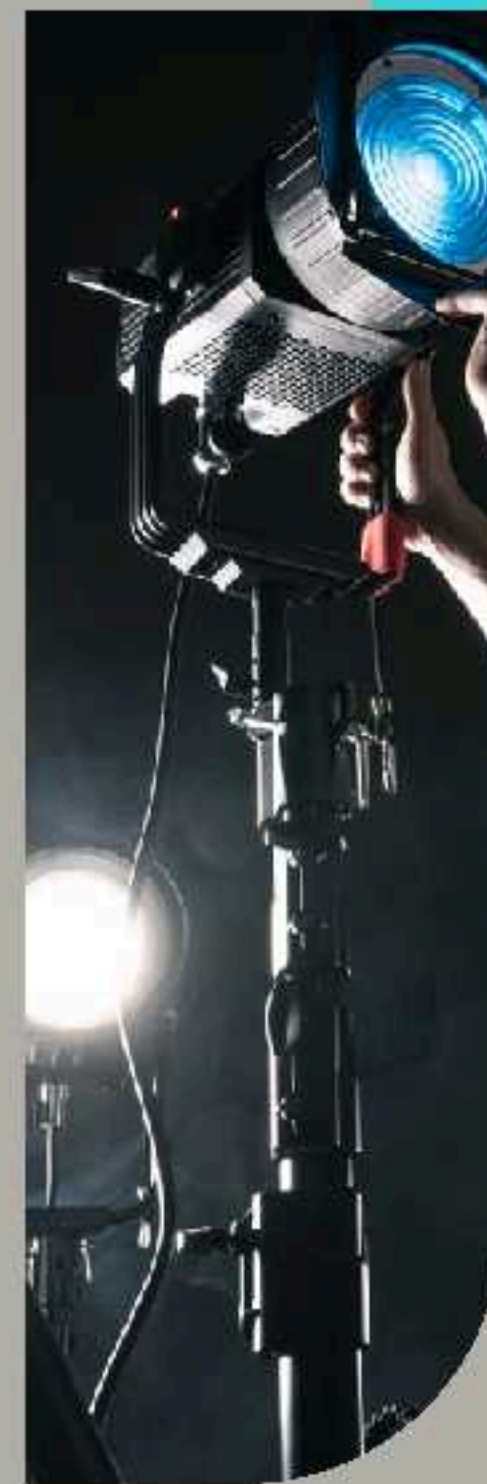

IDEAS GET BUILT HERE

# CONTENTS

- 02 | WHAT **QUANTUM9** IS
- 03 | **WHAT** WE BUILD
- 04 | **HOW** WE WORK
- 05 | EVERYTHING **UNDER THE SAME ROOF**
- 06 | CONNECTED **PRODUCTION CAPABILITIES**
- 07 | PRODUCTION **INFRASTRUCTURE**
- 09 | SELECTED **CLIENTS & PARTNERS**
- 10 | ONE CONNECTED **TEAM**
- 11 | SAMPLES OF **OUR WORK**

# WHAT QUANTUM9 IS

Quantum9 develops production systems for exhibition, retail and live environments across the European Union.

From technical planning and fabrication to delivery and installation, every project is built through connected in-house workflows designed for speed, consistency and execution control.



# WHAT WE BUILD

EXHIBITION STANDS



RETAIL & POS DISPLAYS



BRAND ACTIVATIONS



CUSTOM FABRICATION



# HOW WE WORK



01



## PLANNING & ENGINEERING

Concept development, technical drawings, system design and production planning.

02



## PRODUCTION & ASSEMBLY

CNC machining, fabrication, print, assembly and systems integration.

03



## TESTING & QUALITY CONTROL

Functional testing, quality checks and system validation before delivery.

04

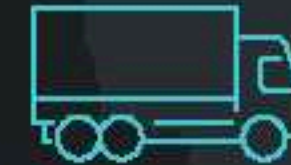

## PACKAGING & DELIVERY

Professional packaging, transport coordination and on-site installation support.

# EVERYTHING UNDER THE SAME ROOF

Everything happens inside the same operational ecosystem.



BTL creatives, technical designers, engineers, fabricators, print operators, logistics teams and installation crews work inside the same operational ecosystem.

This connected workflow speeds up decision-making, shortens production timelines and keeps implementation aligned from concept to installation.

Instead of managing multiple vendors, clients work with one integrated team built for complex projects.

# CONNECTED PRODUCTION CAPABILITIES

Everything happens inside the same operational ecosystem.



## DESIGN & ENGINEERING

Art direction, 3D design, technical drawings and production-ready files.



## CNC & FIBER LASER

Precision CNC machining and fiber laser cutting for metal, wood and aluminum.



## WELDING & ASSEMBLY

Metal, wood and mixed-material fabrication with full assembly.



## MECHANICS & ELECTRONICS

Integrated motors, sensors and control systems for functional installations.



## PROGRAMMING & SYNC

Custom software and automation systems for synchronized installations.



## PRINT & BRANDING

Large-format printing, lamination and vinyl application for branded surfaces.

# PRODUCTION INFRASTRUCTURE



## 01 LASER

### Fiber Laser Cutter

High-speed metal cutting, precision engraving on steel, aluminum, copper.

Fiber laser systems for precision cutting of metal sheets up to 3000×1500mm. Tolerances under 0.1mm on steel, aluminum, stainless, and copper.



## 02 LASER

### CO2 Laser Systems

Non-metal cutting and engraving - acrylic, wood, MDF, textiles.

CO2 laser for precision cutting and engraving of non-metal materials. Acrylic, wood, MDF, textiles, leather, and composites with fine detail.



## 03 CNC

### CNC Router

Large-format milling for wood, aluminum, composite panel, foam.

CNC routing for 2D and 3D shapes in wood, foam, MDF, composites and aluminum. Large-format milling with Adline Industries precision equipment.



## 04 PRINT

### Ecosolvent Printers

Wide-format printing up to 3.2m, indoor and outdoor durability.

Large-format ecosolvent printing on flexible substrates. Banners, signage, vehicle wraps, and architectural graphics up to 3.2m width.

# PRODUCTION INFRASTRUCTURE



## 05 PRINT

### Flatbed UV Printer

Direct printing on rigid materials - acrylic, dibond, PVC, wood.

SwissQprint UV flatbed for direct printing on rigid substrates. Acrylic, dibond, PVC, wood, glass - high resolution with white ink and varnish.



## 06 METAL

### MIG/TIG Welding

Structural steel, aluminum, and stainless welding for frames and assemblies.

MIG/TIG welding, bending and assembly of steel and aluminum frames. Custom brackets, enclosures, and structural elements built to spec.

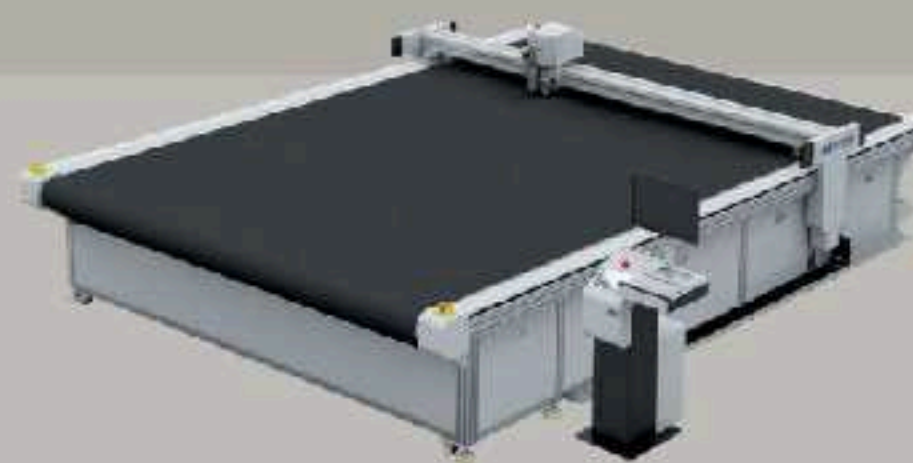

## 07 CUT

### Flatbed Cutter

Contour and kiss-cut for vinyl, cardboard, foam board, magnetic sheet.

JWEI precision flatbed cutter for contour cutting, kiss-cut, and creasing. Vinyl, cardboard, foam board, magnetic sheet, and corrugated materials.



## 08 FINISH

### Lamination & Coating

Protective lamination, anti-UV coatings, gloss and matte finishes.

End-to-end finishing: protective lamination, anti-UV coatings, gloss and matte finishes. Ready for outdoor installation and long-term durability.

# TRUSTED BY

Oxygen

McCANN  
BUCHAREST

GRF+

GODMOTHER

Leo Burnett

\_line

PROPAGANDA

Allianz 

AVON

  
băneasa  
shopping  
city

Coca-Cola

Barilla

BAYER

BRD

DACIA

DELPHI  
ECONOMIC  
FORUM  
Bucharest

ECONOMIST  
IMPACT

ERBAŞU

  
FAN  
FORUM

globalworth  
φφφ

H&M

KRUK

Lidea

Mc.

MedLife

NETAFIM

  
novo nordisk

  
OLYMPUS

ppc

SAMSUNG

STRABAG

TEILOR

UniCredit

vodafone

VICHY  
LABORATOIRES

United Drive

ni

# ONE CONNECTED TEAM



Design, fabrication, electronics, print, logistics and installation working as one connected production system.

CRISTIAN STAN-CRACIU	DAN MLADENOVICI	GHEORGHE FLOREA	IULIAN IONESCU	PETRU CIOBANU	RADU SERBAN	ȘTEFAN BULEANDRA	STEPHAN IULIAN TARACHIU	KHADKA SAGAR	YADAV AMAR	THAKUR RAM	MARIUS ROMAN	LIVIU RUSEN	RICHARD MATEOIU
Printer Operator	CNC & Laser Operator	General Support	Welder	Finishing	Vinyl Applicator	Electronics	Technical Designer	Technical Support	Logistics	Logistics	Assembly & Finishing	Wood Assembly & Finishing	Assembly & Finishing



IDEAS  
GET  
BUILT  
HERE



# DACIA

EXHIBITION BUILD



## Dacia Manifesto Concept Launch

Custom fabrication and installation of a premium showcase environment for the Dacia Manifesto concept vehicle as part of Bucharest Design Week, featuring bespoke structures, mirrored surfaces, integrated lighting, and technical production.

FABRICATION | EXHIBITION BUILD | CUSTOM STRUCTURES | INSTALLATION | TECHNICAL PRODUCTION

BRANDED RETAILACTIVATION

VICHY  
LABORATOIRES

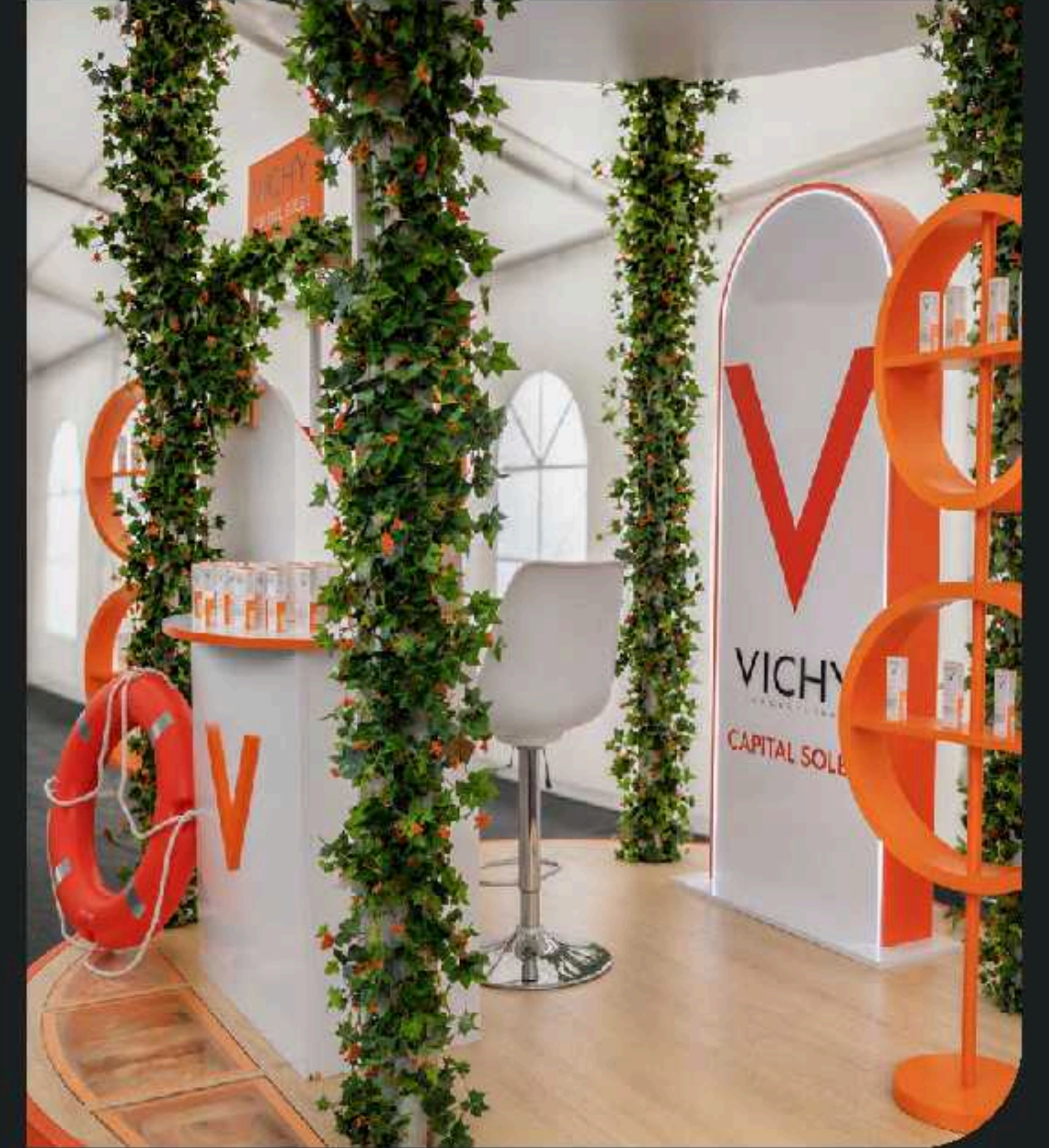

## Vichy Capital Soleil Activation

Branded retail activation, integrating product display, structural elements, and digital screens within a mall environment.

FABRICATION | INSTALLATION | RETAILACTIVATION | DIGITAL | CUSTOM BUILD

# VICHY

LABORATOIRES

BRAND TAKEOVER

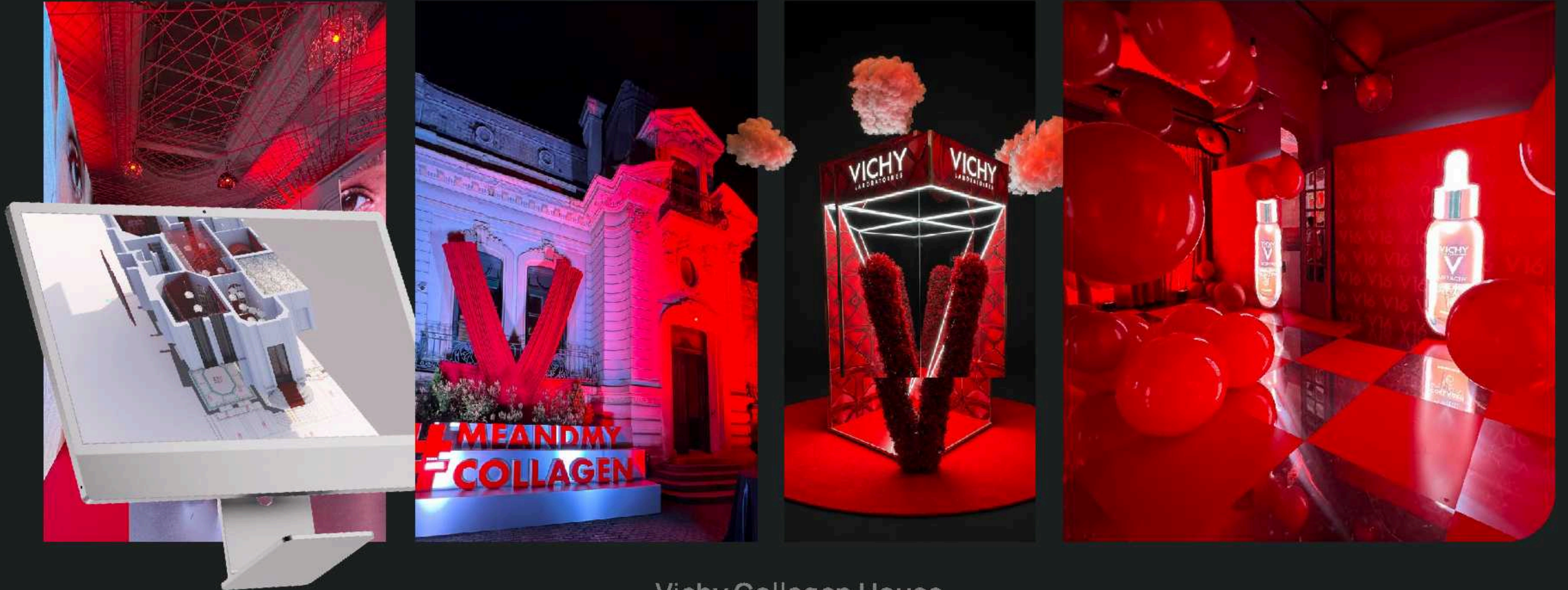

## Vichy Collagen House

Full venue takeover, integrating scenography elements, LED installations, and stage setup across multiple spaces.

FABRICATION | INSTALLATION | SCENOGRAPHY | LED | VENUE TAKEOVER



## UniCredit Pavilion at Bucharest Design Festival

Custom fabrication and installation of a branded pavilion for UniCredit Bank at Bucharest Design Festival, featuring bespoke architectural elements, mirrored surfaces, and custom-produced interior displays.

CUSTOM BUILD | FABRICATION | BRANDED ENVIRONMENT | DISPLAY PRODUCTION | INSTALLATION

CUSTOM FABRICATION



QUAUM 9

CUSTOM FABRICATION

QUANTUM 9

# AFTERGLOW

COLLECTION

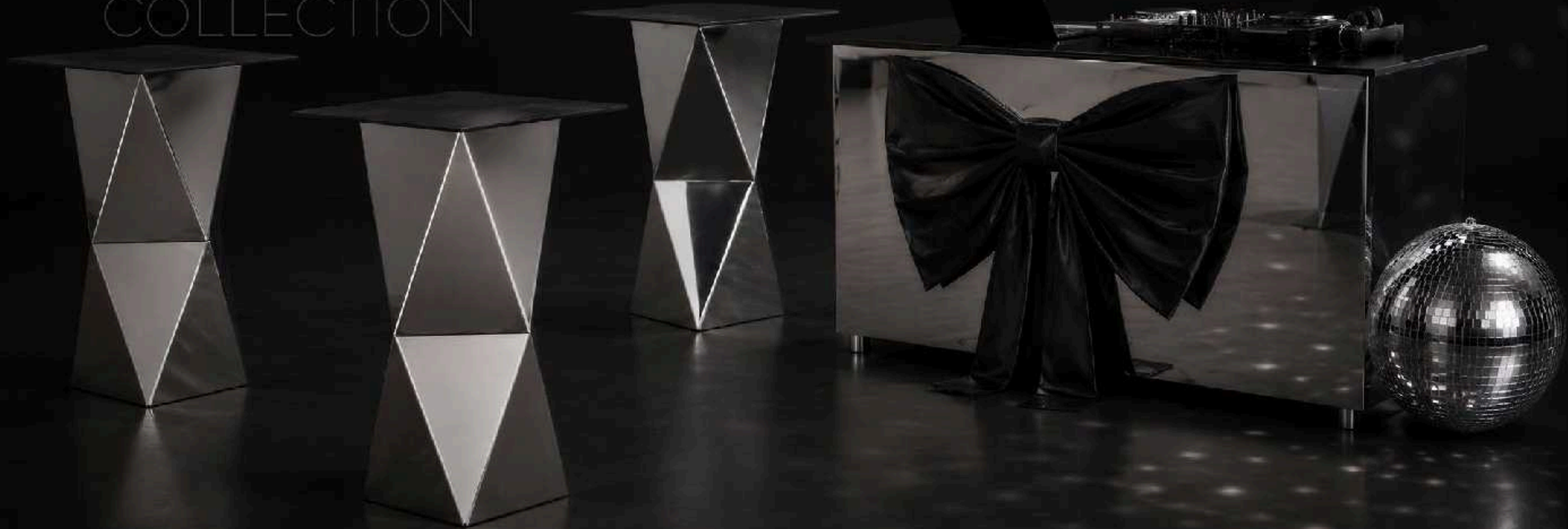

Designed and produced by Q9, Afterglow is a modular event collection defined by reflective surfaces, geometric forms and a distinctive visual presence.

DESIGN | PRODUCTION | MODULAR SYSTEM | PREMIUM FINISHES | EVENT FURNITURE

# QUANTUM 9

CUSTOM FABRICATION





CONFERENCE SETUP



## Coca Cola Sales Conference 2026

Large-scale corporate conference production in Braşov, integrating stage design, LED systems and custom-built content-reactive Coca-Cola bottle installations within an immersive brand environment.

STAGE PRODUCTION | LED SYSTEMS | INTERACTIVE INSTALLATIONS | CUSTOM FABRICATION | CORPORATE EVENT

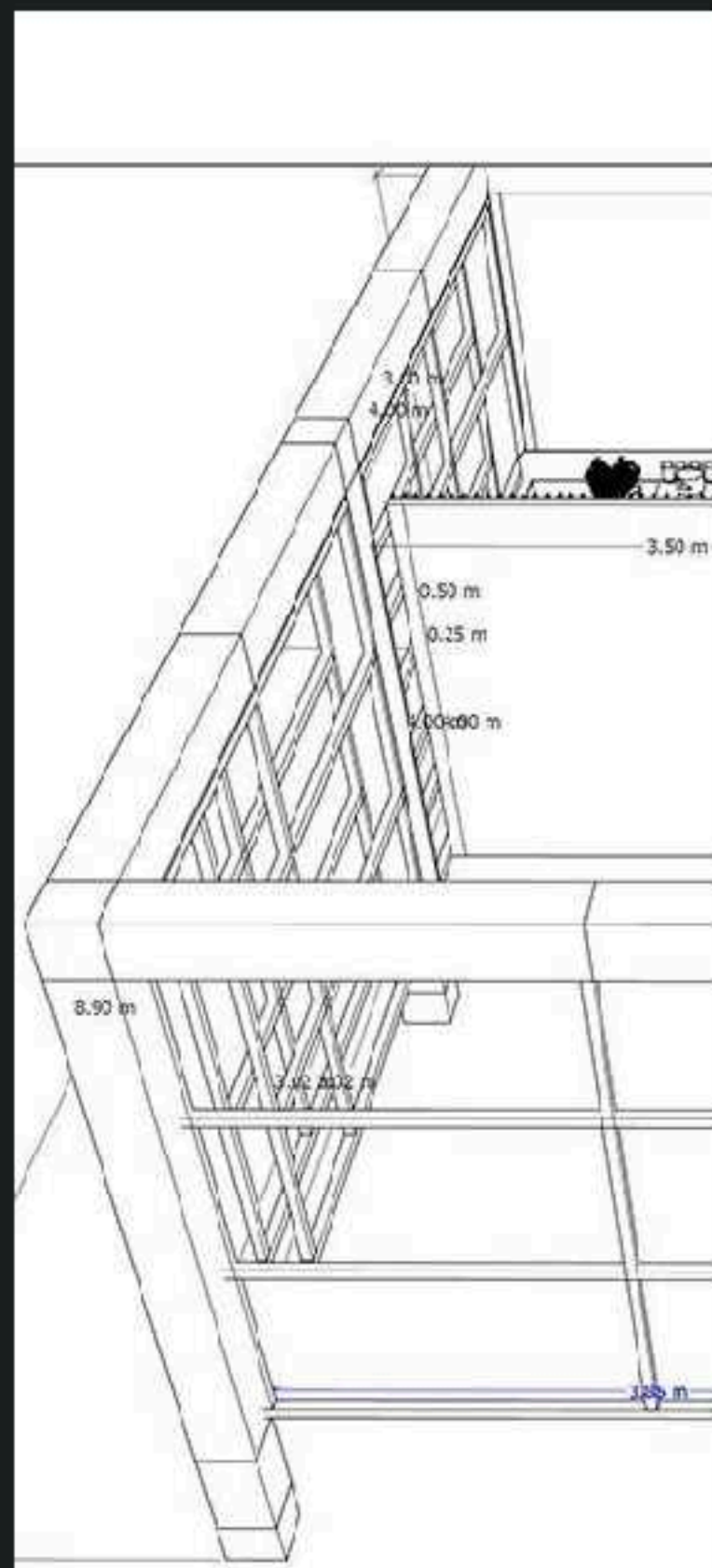

### Barilla Festival Activation

Large-scale festival activation integrating branded booth environments, live cooking experiences and high-traffic audience interaction within complex event contexts. The project required precise production, fast-track installation and seamless on-site coordination to ensure that branding, spatial flow and functional setup remained fully operational throughout the events.

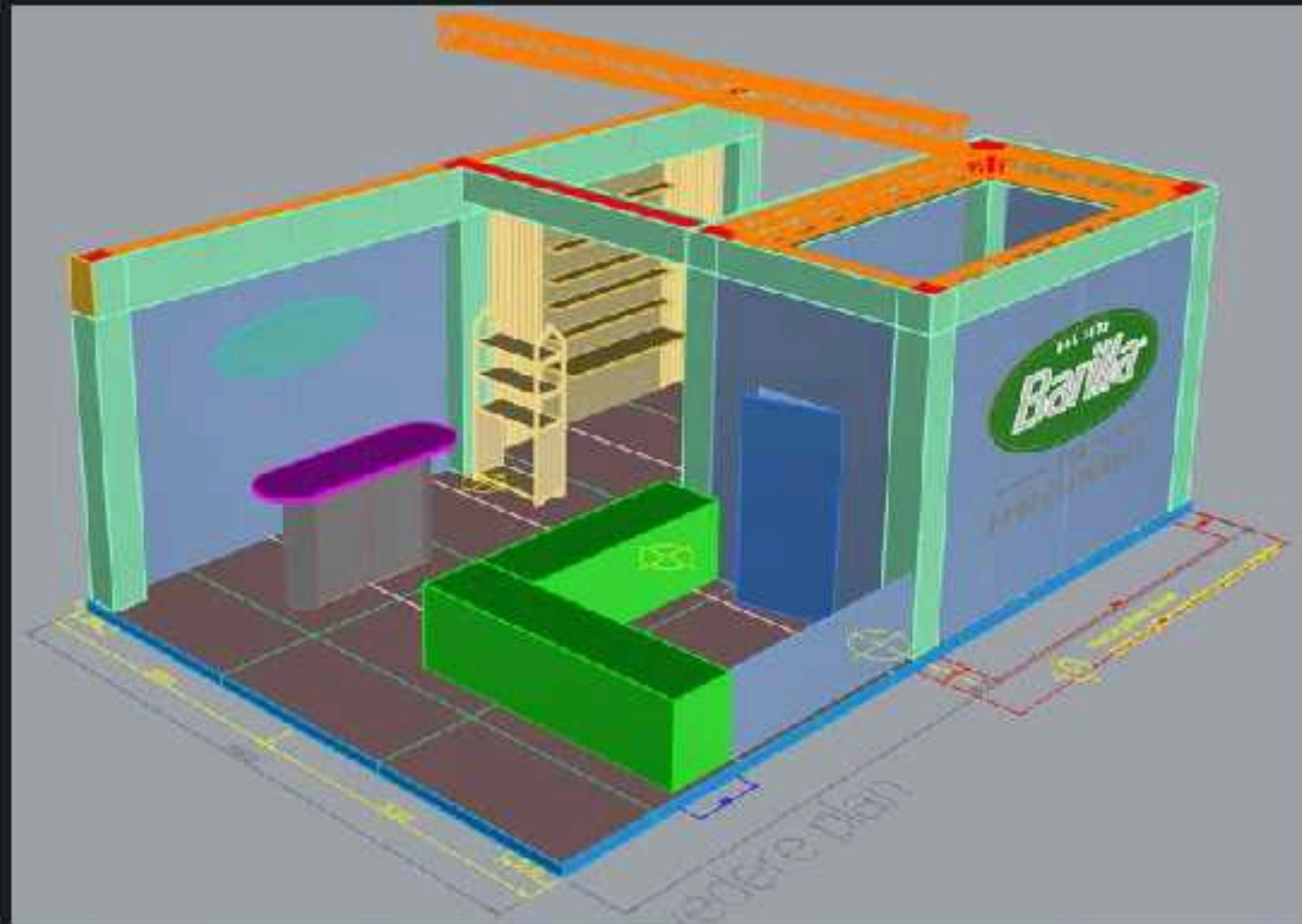

# QUANTUM9

Precision. Fabrication. Control.

## LET'S BUILD YOUR PROJECT

[www.quantum9.eu](http://www.quantum9.eu)



[hello@quantum9.eu](mailto:hello@quantum9.eu)



+40 751 024 954



Bucharest, Mehadia 47



© 2026 Quantum 9 - Bucharest, Romania | Quantumnine Studios SRL | CUI 36444594 | J201601098408

Proudly Made in Romania